

Capacity: 1/8", through 2 1/2"

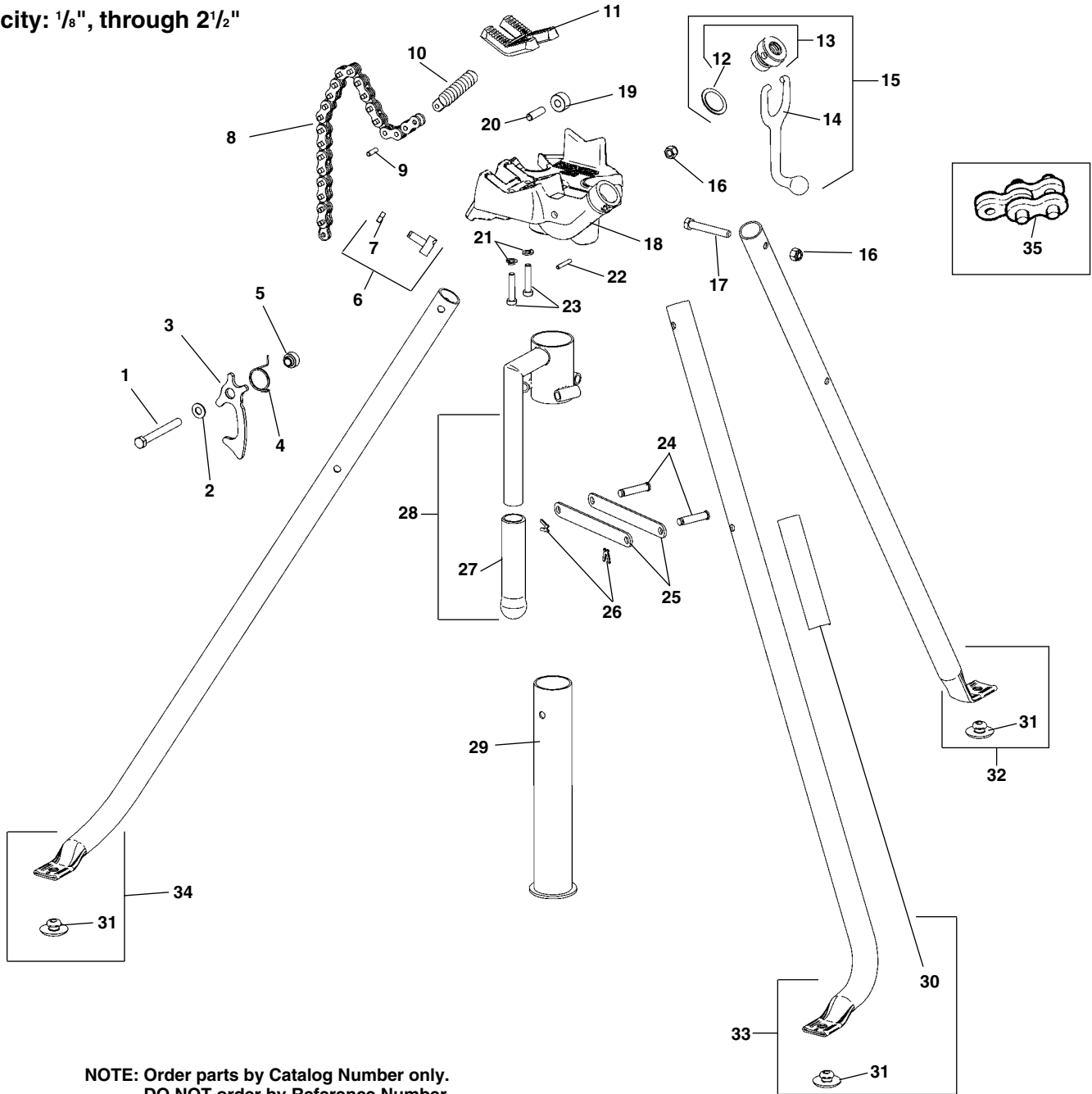

**NOTE: Order parts by Catalog Number only.
DO NOT order by Reference Number.**

Ref. No.	Catalog No.	Description	Ref. No.	Catalog No.	Description
—	16703	425 Tristand	18	19053	Base
1	19063	Hex Bolt, 3/8" - 16 x 3 1/2"	19	40990	Roll
2	59970	Flat Washer, 3/8"	20	41035	Roll Pin
3	19118	Latch	21	40770	Lock Washer, 3/8" (2)
4	19113	Torsion Spring	22	76735	Spring Pin
5	19108	Latch Bushing	23	32457	Screw w/Washer (2)
6	19103	Adjuster Shoe Assembly	24	19083	Pivot Pin (6)
7	83545	Jam Nut, 3/8" - 16"	25	19088	Link (6)
8	41005	Chain Assembly	26	41270	X-Washer (6)
9	41040	Chain Screw Pin	27	18228	Hand Grip
10	41065	Chain Screw	28	19093	Center Ring w/Handle
11	41020	Jaw	29	19098	Center Tube
12	41025	Friction Ring	30	19533	RIDGID Label
13	41060	Swivel Nut w/Friction Ring	31	40940	Grommet (3)
14	41015	Handle	32	19068	Rear Leg Assembly
15	41050	Handle Assembly	33	19078	Right Leg Assembly
16	79985	Lock Nut, 3/8" - 16 (4)	34	19073	Left leg Assembly
17	58052	Hex Bolt, 3/8" - 16 x 2 1/2" (3)	35	68625	Link