

# **RP 306**

## **Press Tools**



## Table of Contents

<b>Safety Symbols</b> .....	<b>2</b>
<b>General Power Tool Safety Warnings *</b> .....	<b>2</b>
Work Area Safety .....	2
Electrical Safety .....	2
Personal Safety .....	2
Power Tool Use And Care .....	3
Battery Tool Use And Care .....	3
Service .....	4
<b>Specific Safety Information</b> .....	<b>4</b>
Press Tool Safety .....	4
<b>Description, Specifications And Standard Equipment</b> .....	<b>4</b>
Description .....	4
Specifications .....	5
Standard Equipment .....	5
<b>Tool And Work Area Set-Up</b> .....	<b>6</b>
<b>Operating Instructions</b> .....	<b>7</b>
Preparing Connection .....	7
Pressing A Fitting With Typical Scissor Jaws .....	7
Pressing A Fitting With Typical Actuator And Press Ring Set .....	8
Inspecting The Pressed Connection .....	9
<b>Storage</b> .....	<b>9</b>
<b>Maintenance Instructions</b> .....	<b>10</b>
Cleaning And Lubrication .....	10
Troubleshooting .....	11
Repair Service .....	11
<b>Optional Equipment</b> .....	<b>12</b>
RP306 Press Tool Accessories .....	12
<b>Disposal</b> .....	<b>12</b>
<b>Electromagnetic Compatibility (EMC)</b> .....	<b>12</b>
<b>EC Declaration of Conformity</b> .....	<b>13</b>
<b>Lifetime Warranty</b> .....	<b>14</b>

## Press Tools



### **⚠ WARNING!**

Read this Operator's Manual carefully before using this tool. Failure to understand and follow the contents of this manual may result in electrical shock, fire and/or serious personal injury.

#### **RP 306 Press Tools**

Record Serial Number below and retain product serial number which is located on nameplate.

Serial  
No.

--

## Safety Symbols

In this operator's manual and on the product, safety symbols and signal words are used to communicate important safety information. This section is provided to improve understanding of these signal words and symbols.

 This is the safety alert symbol. It is used to alert you to potential personal injury hazards. Obey all safety messages that follow this symbol to avoid possible injury or death.

 **DANGER** DANGER indicates a hazardous situation which, if not avoided, will result in death or serious injury.

 **WARNING** WARNING indicates a hazardous situation, which if not avoided, could result in death or serious injury.

 **CAUTION** CAUTION indicates a hazardous situation, which if not avoided, could result in minor or moderate injury.

 **NOTICE** NOTICE indicates information that relates to the protection of property.



This symbol means read the operator's manual carefully before using the equipment. The operator's manual contains important information on the safe and proper operation of the equipment.



This symbol means always wear safety glasses with side shields or goggles while using this equipment to reduce the risk of injury.



This symbol indicates the risk of hands, fingers or other body parts being crushed.



This symbol indicates the risk of electrical shock.

## General Power Tool Safety\*

### WARNING

**Read all safety warnings and instructions. Failure to follow the warnings and instructions may result in electric shock, fire and/or serious injury.**

### **SAVE ALL WARNINGS AND INSTRUCTIONS FOR FUTURE REFERENCE!**

The term "power tool" in the warnings refers to your mains-operated (corded) power tool or battery-operated (cordless) power tool.

### Work Area Safety

- **Keep your work area clean and well lit.** Cluttered or dark areas invite accidents.
- **Do not operate power tools in explosive atmospheres, such as in the presence of flammable liquids, gases, or dust.** Power tools create sparks which may ignite the dust or fumes.
- **Keep children and by-standers away while operating a power tool.** Distractions can cause you to lose control.

### Electrical Safety

- **Power tool plugs must match the outlet. Never modify the plug in any way. Do not use any adapter plugs with earthed (grounded) power tools.** Unmodified plugs and matching outlets will reduce risk of electric shock.

- **Avoid body contact with earthed or grounded surfaces such as pipes, radiators, ranges and refrigerators.** There is an increased risk of electrical shock if your body is earthed or grounded.
- **Do not expose power tools to rain or wet conditions.** Water entering a power tool will increase the risk of electrical shock.
- **Do not abuse the cord. Never use the cord for carrying, pulling or unplugging the power tool. Keep cord away from heat, oil, sharp edges or moving parts.** Damaged or entangled cords increase the risk of electric shock.
- **When operating a power tool outdoors, use an extension cord suitable for outdoor use.** Use of a cord suitable for outdoor use reduces the risk of electric shock.
- **If operating a power tool in a damp location is unavoidable, use a ground fault circuit interrupter (GFCI) protected supply.** Use of a GFCI reduces the risk of electric shock.

### Personal Safety

- **Stay alert, watch what you are doing and use common sense when operating a power tool. Do not use a power tool while you are tired or under the influence of drugs, alcohol, or medication.** A moment of inattention while operating power tools may result in serious personal injury.

\* The text used in the General Power Tool Safety Warnings section of this manual is verbatim, as required, from the applicable UL/CSA 62841-1 standard. This section contains general safety practices for many different types of power tools. Not every precaution applies to every tool, and some do not apply to this tool.

- **Use personal protective equipment. Always wear eye protection.** Protective equipment such as dust mask, non-skid safety shoes, hard hat, or hearing protection used for appropriate conditions will reduce personal injuries.
- **Prevent unintentional starting. Ensure the switch is in the OFF-position before connecting to power source and/or battery pack, picking up or carrying the tool.** Carrying power tools with your finger on the switch or energizing power tools that have the switch ON invites accidents.
- **Remove any adjusting key or wrench before turning the power tool ON.** A wrench or a key left attached to a rotating part of the power tool may result in personal injury.
- **Do not overreach. Keep proper footing and balance at all times.** This enables better control of the power tool in unexpected situations.
- **Dress properly. Do not wear loose clothing or jewelry. Keep your hair, clothing, and gloves away from moving parts.** Loose clothes, jewelry, or long hair can be caught in moving parts.
- **If devices are provided for the connection of dust extraction and collection facilities, ensure these are connected and properly used.** Use of dust collection can reduce dust-related hazards.
- **Do not let familiarity gained from frequent use of tools allow you to become complacent and ignore tool safety principles.** A careless action can cause severe injury within a fraction of a second.

### Power Tool Use And Care

- **Do not force power tool. Use the correct power tool for your application.** The correct power tool will do the job better and safer at the rate for which it is designed.
- **Do not use power tool if the switch does not turn it On and Off.** Any power tool that cannot be controlled with the switch is dangerous and must be repaired.
- **Disconnect the battery pack from the power tool before making any adjustments, changing accessories, or storing power tools.** Such preventive safety measures reduce the risk of starting the power tool accidentally.
- **Store idle power tools out of the reach of children and do not allow persons unfamiliar with the power tool or these instructions to operate the power tool.** Power tools are dangerous in the hands of untrained users.
- **Maintain power tools. Check for misalignment or binding of moving parts, breakage of parts and any other condition that may affect the power tool's operation. If damaged, have the power tool repaired before use.** Many accidents are caused by poorly maintained power tools.
- **Keep cutting tools sharp and clean.** Properly maintained cutting tools with sharp cutting edges are less likely to bind and are easier to control.
- **Use the power tool, accessories and tool bits etc. in accordance with these instructions, taking into account the working conditions and the work to be performed.** Use of the power tool for operations different from those intended could result in a hazardous situation.
- **Keep handles and grasping surfaces dry, clean and free from oil and grease.** Slippery handles and grasping surfaces do not allow for safe handling and control of the tool in unexpected situations.
- **These instructions are generalized practices for several types of press tool attachments. Always follow the specific instructions for the press tool attachment being used and the fitting manufacturers specific installation instructions.**

### Battery Tool Use And Care

- **Recharge only with the charger specified by the manufacturer.** A charger that is suitable for one type of battery pack may create a risk of fire when used with another battery pack.
- **Use power tools only with specifically designated battery packs.** Use of any other battery packs may create a risk of injury and fire.
- **When battery pack is not in use, keep it away from other metal objects, like paper clips, coins, keys, nails, screws or other small metal objects that can make a connection from one terminal to another.** Shorting the battery terminals together may cause burns or a fire.
- **Under abusive conditions, liquid may be ejected from the battery; avoid contact. If contact accidentally occurs, flush with water. If liquid contacts eyes, additionally seek medical help.** Liquid ejected from the battery may cause irritation or burns.
- **Do not use a battery pack or tool that is damaged**

**or modified.** Damaged or modified batteries may exhibit unpredictable behavior resulting in fire, explosion or risk of injury.

- **Do not expose a battery pack or tool to fire or excessive temperature. Exposure to fire or temperature above 265 °F (130 °C) may cause explosion.**
- **Follow all charging instructions and do not charge the battery pack or tool outside the temperature range specified in the instructions.** Charging improperly or at temperatures outside the specified range may damage the battery and increase the risk of fire.

## Service

- **Have your power tool serviced by a qualified repair person using only identical replacement parts.** This will ensure that the safety of the power tool is maintained.
- **Never service damaged battery packs.** Service of battery packs should only be performed by the manufacturer or authorized service providers.

## Specific Safety Information

### **WARNING**

**This section contains important safety information that is specific to this tool.**

**Read these precautions carefully before using the RP306 Press Tool to reduce the risk of electrical shock or serious personal injury.**

### **SAVE THESE INSTRUCTIONS!**

A compartment in the RP306 carrying case is included to keep this manual with the machine for use by the operator.

## Press Tool Safety

- **Use the RP306 Press Tool only with RIDGID® standard pressing attachments (jaws, press ring, actuator, etc.).** Other uses or modifying the RP306 Press Tool for other applications may damage the press tool, damage the attachments and/or cause personal injury.
- **Keep your fingers and hands away from pressing attachments during press cycle.** Your fingers or hands can be crushed, fractured or amputated if they become caught between the jaws or between these components and any other object.

- **Never attempt to repair damaged jaws, press ring, actuator or other attachments.** An attachment that has been welded, ground, drilled or modified in any manner can shatter during pressing resulting in serious injury. Discard the entire damaged jaws. Replace with new jaws. Never replace individual components except for damaged jaw return springs. Please call Ridge Tool Company, Technical Services for availability.
- **Large forces are generated during product use that can break or throw parts and cause injury.** Stand clear during use and wear appropriate protective equipment, including eye protection.
- **Only use RIDGID Press Tools and Jaws when specified by the press fitting manufacturer.** Use of incorrect equipment and methods can cause incomplete joints, damage the equipment, void warranties or cause severe personal injury or death.
- **Use proper tool, attachment and fitting combinations.** Improper combinations can result in an incomplete joint, which increase the risk of leaks, equipment damage and injury.
- **Before operating a RIDGID RP306 press tool, Read and understand:**
  - This operator's manual,
  - The attachment instructions,
  - The battery/charger manual,
  - RPA 120/220 AC Power (Mains) Adapter Instructions,
  - The fitting manufacturer's installation instructions,
  - The instructions for any other equipment used with this tool,

Failure to follow all instructions and warnings may result in property damage and/or serious injury.

## RIDGID Contact Information

If you have any question concerning this RIDGID® product:

- Contact your local RIDGID® distributor.
- Visit RIDGID.com to find your local Ridge Tool contact point.
- Call 400-820-5695.

## Description, Specifications And Standard Equipment

### Description

The RIDGID® RP306 Press Tool, when used with appropriate RIDGID standard pressing attachments, is designed to mechanically press fittings onto tubing



to create a watertight and permanent seal. When the switch on the RP306 is depressed, an internal electric motor powers a hydraulic pump which forces fluid into the cylinder of the tool, forcing the ram forward and applying thousands of pounds of pressing force onto specially designed fittings. Attachments are also available for other uses.

The entire cycle duration is approximately seven (7) seconds. Once the cycle begins to deform a fitting, it will automatically continue until completion, even if the run switch is released. The LED Green light on the back of the tool will blink to indicate issues such as improper temperature, low battery, or maintenance required.

The RP306 comes with two (2) fabric loops that can be used with appropriate attachments such as shoulder straps or tie off lines.

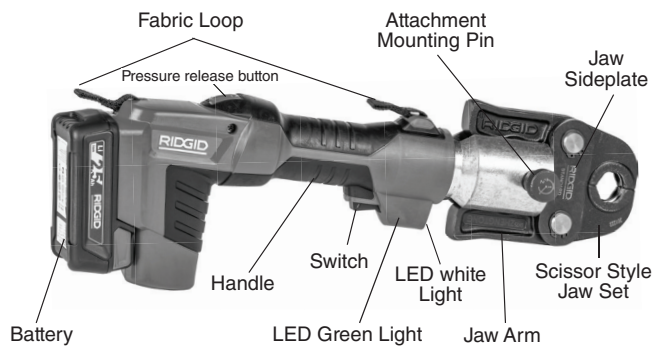

Figure 1 – RP306 Press Tool And Standard Series Jaw



Figure 2 – Machine Serial Number - Circled digits indicate the year and month of the manufacture. (YY = year, MM = month).

## Specifications

Attachments.....RIDGID Standard Series

Motor

Voltage .....18V DC

Amperage .....18 Amp

Power .....324 Watts

Weight.....2.6 Kg (Tool Only - No Battery)

Ram Force .....32 kN

Operating Temperature

Range .....15° F to 122° F (-10°C to 50°C)

Duty Cycle.....3 Press /min.

Sound Pressure (LPA)\* .....83.2 dB(A), K=3

Sound Power (LWA)\* .....72.2 dB(A), K=3

Vibration\* .....< 1.468 m/s<sup>2</sup>, K=1.5

\* Sound and Vibration measurements are measured in accordance with a standardized test per Standard EN 62481-1.

- Vibration levels may be used for comparison with other tools and for preliminary assessment of exposure.
- Sound and vibration emissions may vary due to your location and specific use of these tools.
- Daily exposure levels for sound and vibration need to be evaluated for each application and appropriate safety measures taken when needed. Evaluation of exposure levels should consider the time a tool is switched OFF and not in use. This may significantly reduce the exposure level over the total working period.

## Standard Equipment

The RP306, if ordered with batteries, comes with 2.0Ah batteries. 4.0 batteries are available as accessories (See Page 24). Higher amp-hour batteries allow more press connections per charge, but also weigh more.

NOTE! RIDGID jaws and attachments are offered in two "series"

- Standard Series
- Compact Series

These series are not interchangeable. Only standard series jaws will work with standard series tools (RP 330, RP 340, RP318, RP306).

Similarly, only compact series jaws will work with the compact series tools (Compact 100-B, RP 200-B, RP 210-B).

**NOTICE** Selection of appropriate materials and joining methods is the responsibility of the system designer and/or installer. Before any installation is attempted, careful evaluation of the specific service environment, including chemical environment and service temperature, should be completed. Consult Press Fitting System manufacturer for selection information.

## Tool Inspection

### ⚠ WARNING



**Daily before use, inspect your press tool and correct any problems to reduce the risk of serious injury from electric shock, crushing injuries, attachment failure and other causes, and prevent tool damage.**

1. Make sure that the press tool battery/power adapter is removed. Inspect the battery for damage. If any damage or modifications are found, do not use until the battery has been properly repaired or replaced.
2. Clean any oil, grease or dirt from the equipment, especially the handles and controls. This helps to prevent the machine or controls from slipping from your grip.
3. Inspect the press tool for the following:
  - Proper assembly, maintenance and completeness.
  - Any broken, worn, missing, misaligned or binding parts.
  - Make sure that the attachment mounting pin moves smoothly between the fully open and fully closed positions (Figure 4 and 5).
  - Confirm that the switch moves freely and does not bind or stick.
  - Presence and readability of the warning label (Figure 3).
  - Check that the fabric loops are undamaged and that the stitching is not torn.
  - any other condition which may prevent safe and normal operation.

If any problems are found, do not use the press tool until the problems have been repaired.

4. Inspect and maintain the tool attachments, battery and charger as directed in their instructions.
5. With dry hands, insert a fully charged battery. Press the red switch one time in order to turn the press tool ON. The LED light should turn ON and remain on to indicate that the tool is ready for use. If any other conditions exist, use the Diagnostic Codes information (Figure 11) to determine the next step and do not use the tool until it is working properly. With your hands and fingers away from the tool attachment during press cycle, test the operation of the switch to confirm proper operation. When used with an attachment, once the tool sees enough load it will lock on to ensure that a complete press is made.
6. Once the operation has been checked, with dry hands remove the battery.

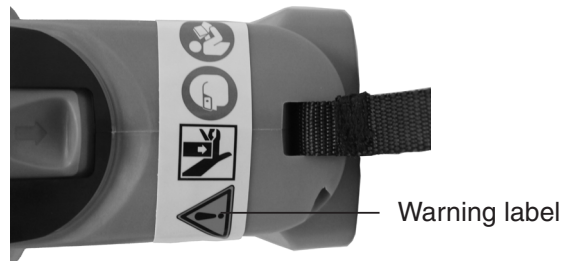

Figure 3 - Warning label of the crimping tool

## Tool And Work Area Set-Up

### ⚠ WARNING



**Set up the press tool and work area according to these procedures to reduce the risk of injury from electric shock, fire, crushing injuries and other causes, and prevent tool and system damage.**

1. Check work area for:
  - Adequate lighting.
  - Flammable liquids, vapors or dust that may ignite. If present, do not work in area until sources have been identified and corrected. The press tool is not explosion proof and can cause sparks.
  - Clear, level, stable and dry place for operator. Do not use the machine while standing in water.
  - Warning label exists and is readable (Fig. 3)
2. Inspect the work to be done and determine the correct RIDGID tool and attachment(s) for the application. Using an incorrect attachment for an application can cause injury, damage the tool and make incomplete connections. For a complete listing of RIDGID attachments available for this tool, see the Ridge Tool Catalog on line at [www.RIDGID.com.cn](http://www.RIDGID.com.cn) or call Ridge Tool Technical Services 400-820-5695. Make sure that the tool and attachment have been inspected as directed in their instructions.
3. Evaluate the work area and determine if any barriers are needed to keep bystanders out. Bystanders can distract the tool operator during use.

## Removing/Installing Attachment

- a. Remove battery from tool.
- b. Open the attachment mounting pin:
  1. Slightly push the attachment mounting pin
  2. Twist counterclockwise by about 45° to open.
- c. Remove/insert the appropriate attachment (Figure 4/5).
- d. Push to fully close the attachment mounting pin until it locks into the closed position. Attachment mounting pin must be fully closed to prevent tool damage during use.



## Operating Instructions

### ⚠ WARNING



**Always wear eye protection to protect your eyes against dirt and other foreign objects.**

**Keep your fingers and hands away from the tool attachment during the press cycle. Your fingers or hands can be crushed, fractured or amputated in the attachment or tool or between the attachment, work piece and other objects.**

**Follow operating instructions to reduce the risk of injury from crushing and other causes and to prevent tool damage.**

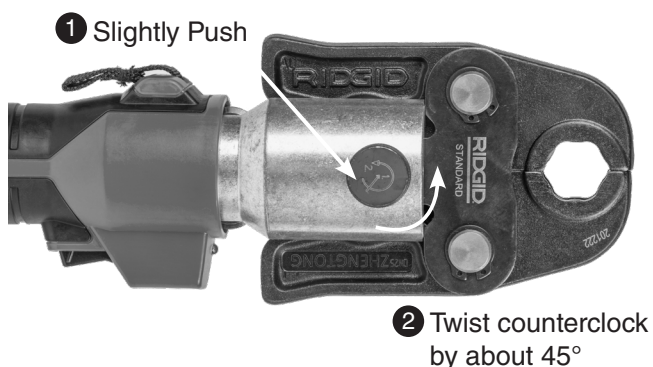

Figure 4 - Fully Closed/Locked Mounting Pin



Figure 5 - Fully Open/Unlocked Mounting Pin

## Preparing Connection

**NOTICE** These instructions are generalized practices for several types of press tool attachments. Always follow the specific instructions for the press tool attachment being used and the fitting manufacturers' specific installation instructions to reduce the risk of improper press connections and extensive property damage.

1. Prepare the press connection according to the fitting manufacturer's instructions.
2. With dry hands, insert a fully charged battery or AC Adapter into tool. If using the corded power adapter with a GFCI, the GFCI (RCD) should have a rated residual current of 30 mA or less.

## Pressing A Fitting With Typical Scissor Jaws

1. Make sure the RP306 Press Tool has the correct jaw installed and the attachment mounting pin is fully closed and locked. (See Tool And Work Area Set Up Section.)
2. Insert fully charged battery or AC Adapter into the base of the handle.
3. Squeeze jaw arms to open the jaws (Figure 6).
4. Place open jaws around the fitting (Figure 7). Make sure the contour of the jaws is properly aligned with the contour of the fitting as specified in Fitting Systems operator's manual. Do not attempt to hang the jaws and tool from fitting. Tool could unexpectedly drop and cause serious injury or death.
5. Make sure the tubing is inserted to the proper depth in fitting, as specified in the appropriate fitting system's instructions.

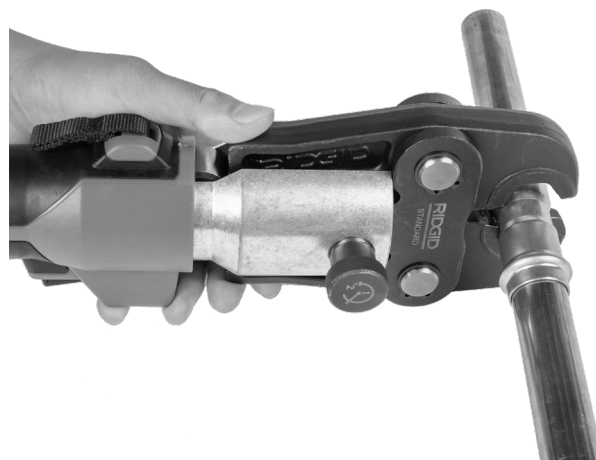
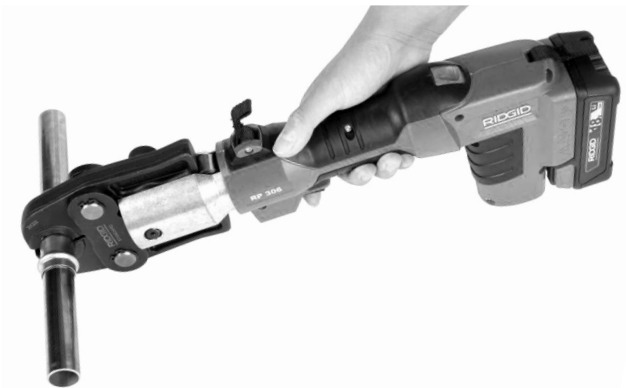
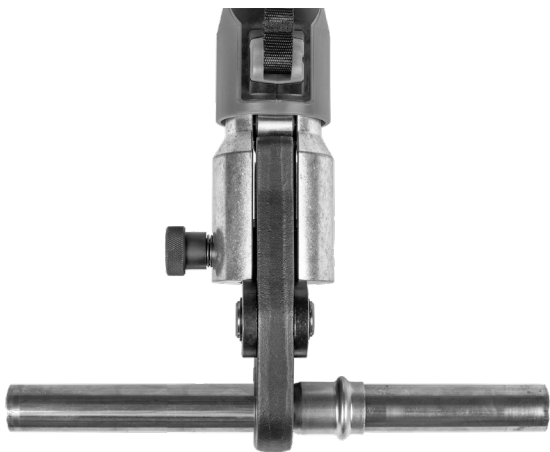

Figure 6 – Opening The Scissor-Style Jaws



**Figure 7 – Placing Scissor-Style Jaw Set Around Fitting**



**Figure 8 – RP306 Tool Square To Tubing**

6. Make sure the jaws and tool are square to the tubing. (Figure 8) If the jaw and tool are not square to the tube, they will try to align as the press is made. This could cause an improperly pressed fitting or damage the tool.
7. Depress and release the switch one time to turn tool ON. The LED light on the front of the tool should be solidly illuminated indicating the tool is ready to press.

**NOTE!** Tool will automatically turn OFF if left unused for 150 seconds. To turn tool ON, it is necessary to once again depress the switch.

Depress the tool trigger switch (Figure 1). Keep fingers and hands away from the jaws to avoid crushing injuries in jaws and between jaws and surroundings. The press cycle takes about seven (7) seconds. Once a press cycle begins and the rollers contact the jaw arms, the tool will lock-on and automatically complete the press cycle. Releasing the trigger will stop the tool once the pressing process has begun. Pressing the switch again, tool will continue until completion. This assures consistent, repeatable press joint integrity.

**NOTICE** The RP306 Press Tool will turn off automatically if the battery is too low to successfully complete a pressed connection. This will be indicated by a continuous ON/OFF flashing of the LED light. A fully charged battery should be inserted in the tool and the pressed connection should be repeated as indicated above.

To retract the rollers and remove the tool from the fitting if battery dies or tool malfunctions during pressed connection. If it is necessary to retract the rollers to remove the tool from the fitting, press the pressure release button (Figure 1). If this happens, the connection will need to be pressed again to insure completion.

8. After cycle is complete, squeeze actuator arms to open and separate actuator from press ring Attachments.
9. Remove the RP306 and jaws from tube and inspect the pressed connection. Avoid sharp edges that may have formed on the fitting during the pressing operation.

tool will continue until completion. This assures consistent, repeatable press joint integrity.

### **Pressing A Fitting With Typical Actuator And Press Ring Set**

1. Make sure the RP306 Press Tool has the correct actuator installed and the mounting pin is fully closed and locked.
2. Insert fully charged battery into the back of the RP306.
3. Make sure the tubing is inserted to the proper depth in fitting, as specified in the appropriate fitting system's operator's manual.
4. Open the appropriate press ring and place at right angle onto the fitting (Figure 8). Align ring with fitting according to fitting system's operator's manual. Recheck insertion depth before completing press process.
5. Squeeze actuator arms to open the actuator assembly. Engage actuator ends into the actuator pockets in the press ring (Figure 10). Make sure actuator ends are fully engaged in pockets. Do not attempt to hang tool and actuator from press ring. Tool could unexpectedly drop causing serious injury or death.
6. Depress and release the switch one time to turn tool ON. The LED light on the front of the tool should solidly illuminate indicating the tool is ready to press.

**NOTE!** Tool will automatically turn OFF if left unused for 150 seconds. To turn tool ON, it is necessary to once again depress and release the switch of the tool.

Depress the tool switch. Keep fingers and hands away from actuator and press ring to avoid crushing injuries in attachments and between attachments and surroundings. The press cycle takes about seven (7) seconds. Once a press cycle begins and the rollers contact the actuator arms, the tool will lock-on and automatically complete the press cycle. Releasing the trigger will stop the tool once the pressing process has begun. Pressing the switch again, tool will continue until completion. This assures consistent, repeatable press joint integrity.



**Figure 9— Installing Press Ring Onto Fitting**



**Figure 10 – Attaching Actuator To Press Ring**

**NOTICE** The RP306 Press Tool will turn off automatically if the battery is too low to successfully complete a pressed connection. This will be indicated by a continuous ON/OFF flashing of the LED light. A fully charged battery should be inserted in the tool and the pressed connection should be repeated as indicated above.

To retract the rollers and remove the tool from the fitting if battery dies or tool malfunctions during pressed connection. If it is necessary to retract the rollers to remove the tool from the fitting, press the pressure release button (Figure 1). If this happens, the connection will need to be pressed again to insure completion.

8. After cycle is complete, squeeze actuator arms to open and separate actuator from press ring. Remove the press ring from fitting by manually grasping ring halves and opening assembly. Avoid any sharp edges which may have formed on fitting during pressing operation.

### Inspecting The Pressed Connection

1. Inspect the pressed fitting. If the fitting is supplied with a control ring and/or a control label by the fitting manufacturer, remove it. Control rings and labels are supplied by the manufacturer to indicate that the fitting has not yet been pressed. Removal of the control ring and label indicates to others that the connection has been pressed.

Look for the following:

- Excessive misalignment of the tubes. Note that a slight amount of misalignment at the pressed connection is considered normal.
- Tubes that are not fully inserted into the fitting – double check the insertion marks made on the tube to see that they are still aligned with the end of the fitting.
- Incorrect jaw or ring alignment with the fitting contour, distorted or deformed fitting.
- Any other issues per the fitting manufacturer.

If any of these problems are found, then removal of the fitting is required and a new fitting and tube will need to be prepared and pressed in its place.

2. Test system in accordance with normal practice and local codes.
3. See fitting system's operator's manual for specific inspection criteria.

### Storage

Remove battery from tool and store tool and battery in case. Avoid storing the tool, batteries or charger in extreme heat or cold. The tool temperature sensor will not allow the tool to turn on if oil temperature is not within the temperature range of 15°F (-10°C) to 122°F (50°C). So it may be necessary to allow the tool to warm or cool to a temperature within the operating range by placing it in a conditioned room before use. This will be indicated by two flashes and a pause continuously, of the LED light on the front of the tool.

**⚠ WARNING** Store tool in a dry, secured, locked area that is out of reach of children and people unfamiliar with the press tool. The tool is dangerous in the hands of untrained users.

## Maintenance Instructions

### **WARNING**

**Make sure battery is removed from tool before performing maintenance or making any adjustment.**

### **Cleaning And Lubrication**

1. Wipe the tool clean daily with a clean dry cloth.
2. Inspect the attachment mounting pin and lubricate the pin with silicone lubricant as needed.
3. Check return springs in attachments with each use. Attachments should open and close freely with only moderate finger effort required.

### **Required Maintenance At RIDGID Authorized Service Center**

Maintenance service is chargeable.

## Troubleshooting

SYMPTOM	POSSIBLE REASONS	SOLUTION
Tool will not turn ON when switch is pressed.	Battery is completely discharged or battery has failed.	Insert fully charged battery/replace battery.
	Battery not properly inserted into handle of tool	Check to assure battery/adaptor is fully inserted.
	Correctly insert AC adapter into tool	
Jaws are locked onto fitting.	Press was not successfully completed.	Push pressure release valve to remove jaws from fitting. Inspect and repress fitting.
The pressed connections produced are not complete.	Used wrong jaws for the tube size or material.	Install the correct jaws.
	The tool was not square to the tube.	Redo the joint with new fitting and new tube. Make sure that the tool is square to the tube.
	Jaw contour was not aligned with the fitting contour.	Redo the joint with new tube and new fitting. Make sure the jaw contour is aligned with the fitting contour.
	Tool is in need of repair.	Contact RIDGID Technical Service Department at 400-820-5695 for nearest Authorized Press Tool Service center.

## LED Display Status

	STATUS	REMARK
LED Green Light	On	Normal.
	Flashing	The battery is low and needs to be replaced.
	Off	The machine has failed and needs to be repaired.
LED White Light	On	It is always on when the green light is always on.
	Off	The white light is off one minute after the green light off. The green light and the white light are off at the same time when the machine fails, and it needs to be repaired.

Figure 11 – LED Diagnostic Codes

## Service And Repair

### WARNING

**Improper service or repair can make tool unsafe to operate.**

Service and repair on the RP 306 Press Tool must be performed by a RIDGID Independent Press Tool Service Center.

For information on your nearest RIDGID Authorized Independent Service Center or any service or repair questions see Contact Information section in this manual.



## Optional Equipment

### ⚠ WARNING

The following tool accessories have been designed to function with the RP306 Press Tools.

Other accessories suitable for use with other tools may create hazards when used on the RP306.

To prevent serious injury, use only accessories specifically designed and recommended for use with the RP306, such as those listed below.

Ridge Tool Company provides standard pressing attachments designed specifically for use with RIDGID Standard Press Tools. Only use attachments that are specifically designed to press the fitting system you are installing. For a complete listing of RIDGID attachments available for this tool, see the Ridge Tool Catalog online at [www.RIDGID.com.cn](http://www.RIDGID.com.cn) or call Ridge Tool Technical Services 400-820-5695.

Catalog No.	Description
56513	18V 2.5 Advanced Lithium Battery Pack
56518	18V 5.0 Advanced Lithium Battery Pack
64388	18V Advanced Lithium Charger
47133	Carrying Case (Plastic)
44823	China AC Power Adapter

## Disposal

Parts of these tools contain valuable materials and can be recycled. There are companies that specialize in recycling that may be found locally. Dispose of the components in compliance with all applicable regulations. Contact your local waste management authority for more information.



**For EC Countries:** Do not dispose of electrical equipment with household waste!

According to the European Guideline 2012/19/ EU for Waste Electrical and Electronic Equipment and its

implementation into national legislation, electrical equipment that is no longer usable must be collected separately and disposed of in an environmentally correct manner.

## Electromagnetic Compatibility (EMC)

The term electromagnetic compatibility is taken to mean the capability of the product to function smoothly in an environment where electromagnetic radiation and electrostatic discharges are present and without causing electromagnet interference to other equipment.

**NOTICE** These tools conform to all applicable EMC standards. However, the possibility of them causing interference in other devices cannot be precluded. All EMC related standards that have been tested are called out in the tool's technical document.

## EC Declaration

RIDGE TOOL COMPANY  
400 Clark Street  
Elyria, Ohio 44035-6001  
U.S.A.  
RTCRegulatory.Compliance@Emerson.com

### EC DECLARATION OF CONFORMITY

We declare that the machines listed above, when used in accordance with the operator's manual, meet the relevant requirements of the Directives and Standards listed below.

### DÉCLARATION DE CONFORMITÉ CE

Nous déclarons que lorsqu'elles sont utilisées selon leur mode d'emploi, les machines indiquées ci-dessus répondent aux exigences applicables des directives et normes ci-après.

### DECLARACIÓN DE CONFORMIDAD DE LA CE

Declaramos que las máquinas listadas más arriba, cuando se usan conforme al manual del operario, cumplen con los requisitos pertinentes de las directrices y normas listadas a continuación.

### PROHLÁŠENÍ O SHODĚ ES

Prohlašujeme, že výše uvedené nástroje a zařízení splňují při použití v souladu s jejich návodem k obsluze příslušné požadavky níže uvedených směrnic a nařízení.

### EF-OVERENSSTEMMELSESERKLÆRING

Vi erklærer, at de ovenfor anførte maskiner, ved brug i overensstemmelse med brugervejledningen, opfylder de relevante krav i de nedenfor anførte direktiver og standarder.

### EG KONFORMITÄTSEERKLÄRUNG

Wir erklären, dass die oben aufgeführten Maschinen, wenn sie entsprechend der Bedienungsanleitung verwendet werden, die einschlägigen Anforderungen der folgenden Richtlinien und Normen erfüllen.

### ΔΗΛΩΣΗ ΣΥΜΜΟΡΦΩΣΗΣ ΕΚ

Δηλώνουμε ότι τα μηχανήματα που αναφέρονται παραπάνω, όταν χρησιμοποιούνται σύμφωνα με το εγχειρίδιο χειρισμού, πληρούν τις σχετικές απαιτήσεις των παρακάτω Οδηγιών και Προτύπων.

### EY-VAATIMUSTENMUKAISUUSVAKUUTUS

Vakuutamme, että edellä luetellut koneet täyttävät käyttöohjekirjan mukaisesti käytettynä seuraavien direktiivien ja standardien vaatimukset.

### EU IZJAVA O SUKLADNOSTI

Izjavljujemo da su gore navedeni strojevi, kada se koriste u skladu s priručnikom za korisnike, sukladni s relevantnim zahtjevima dolje navedenih direktiva i standarda.

### EK MEGFELELŐSÉGI NYILATKOZAT

Kijelentjük, hogy a fent felsorolt gépek - amennyiben a kezelési útmutatónak megfelelően használják őket - megfelelnek az alább felsorolt irányelvek és Szabványok követelményeinek.

### DICHIARAZIONE DI CONFORMITÀ CE

Dichiariamo che le macchine elencate in alto, se utilizzate in conformità con il manuale dell'operatore, soddisfano i relativi requisiti delle Direttive e degli Standard specificati di seguito.

### EO СӘЙКЕСТІК МӘЛІМДЕМЕСІ

Біз жоғарыда көрсетілген құрылғылардың пайдаланушы нұсқаулығына сәйкес пайдаланылған жағдайда төменде көрсетілген Директивалар мен Стандарттардың тиісті талаптарына жауап беретінін мәлімдейміз.

### EG-CONFORMITEITSVERKLARING

Hierbij verklaren wij dat de hierboven vermelde machines, mits gebruikt in overeenstemming met de handleiding, voldoen aan de relevante eisen van de hieronder vermelde richtlijnen en normen.

### CE-SAMSVARERKLÆRING

Vi erklærer at maskinene oppført over oppfylder de relevante kravene i direktiver og standarder oppført under dersom de brukes i henhold til bruksanvisningene.

Ridge Tool Europe N.V.  
Ondernemerslaan 5428  
3800 Sint-Truiden, Belgium  
europeproductcompliance@emerson.com  
+40 374132035

### DEKLARACJA ZGODNOŚCI WE

Deklarujemy, że maszyny wymienione powyżej, gdy są używane zgodnie z podręcznikiem użytkownika, spełniają właściwe wymagania Dyrektyw i Stan- dardów, wymienione poniżej.

### DECLARAÇÃO DE CONFORMIDADE CE

Declaramos que as máquinas listadas acima, quando utilizadas de acordo com o manual do operador, cumprem os requisitos relevantes das Diretivas e Normas listadas abaixo.

### DECLARAȚIE DE CONFORMITATE CE

Declarăm că mașina specificată mai jos, atunci când este utilizată în conformitate cu manualul de exploatare, îndeplinește cerințele relevante ale Directivelor și standardelor specificate mai jos.

### ДЕКЛАРАЦИЯ СООТВЕТСТВИЯ ЕС

Мы заявляем, что инструменты, перечисленные выше, при условии их использования согласно руководству по эксплуатации, отвечают соответствующим требованиям указанных ниже директив и стандартов.

### ES PREHLÁSENIE O ZHODE

Vyhlasujeme, že stroje uvedené vyššie spĺňajú relevantné požiadavky smerníc a noriem uvedených nižšie, ak sa používajú podľa návodu na použitie.

### IZJAVA ES O SKLADNOSTI

Izjavljamo, da zgoraj omenjeni stroji, ko se uporabljajo skladno z uporabniškim priročnikom, izpolnjujejo relevantne zahteve spodaj omenjenih direktiv in stan- dardov.

### EC DEKLARACIJA O USAGLAŠENOSTI

Izjavljujemo da gore navedeni strojevi, ako se koriste u skladu s priručnikom za korisnike, zadovoljavaju relevantne zahteve direktiva i standarda koji se navode dole.

### EG-FÖRSÄKRAN OM ÖVERENSSTÄMMELSE

Vi meddelar att maskinen som anges ovan uppfyller de aktuella kraven i de angivna direktiven och standarderna nedan när den används enligt bruksan- visningen.

### AB UYGUNLUK BEYANI

Yukarıda listelenen makinelerin, kullanıcı kılavuzuna göre kullanıldığında, aşağıda listelenen Direktiflerin ve Standartların ilgili gereksinimlerini karşı- ladığını beyan ederiz.

### EÜ VASTAVUSDEKLARATSIION

Kinnitame, et eelpool loetletud masinad vastavad allpool loetletud direktii-vide ja standardite asjakohastele nõuetele, kui neid kasutatakse vastavalt kasu- tusjuhendile.

### EK ATBILSTĪBAS DEKLARĀCIJA

Mēs apliecinām, ka iepriekšminētās iekārtas, izmantojot tās saskaņā ar op- eratora rokasgrāmatu, atbilst attiecīgajām tālāk norādīto direktīvu un standartu prasībām.

### DEARBHÚ COMHRÉIREACHTA AN CE

Fógraímid go bhfuil na hinnill sa liosta thuas i gcomhréir le riachtanais ábhartha na dTeoracha agus na gCaighdeán sa liosta thíos, ach iad a úsáid de réir an lámhleabhair don oibreoir.

### EB ATITIKTIES DEKLARACIJA

Deklaruojame, kad pirmiau išvardytos mašinos, jei naudojamos pagal nau- dotojų vadovą, atitinka atitinkamus toliau išvardytų direktyvų ir standartų reikalavimus.

### EO ДЕКЛАРАЦИЯ ЗА СЪОТВЕТСТВИЕ

Декларираме, че изброените по-горе машини, когато се използват в съответствие с Ръководство за оператора, отговарят на съответните изисквания на директивите и стандартите, изброени по-долу.



2006/42/EC, 2014/30/EU, 2011/65/EU  
IEC 62841-1, EN55014-1, EN55014-2, EN 61000-3-2, EN 61000-3-3, EN62841-1

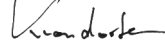

Signature:   
Name: Harald Kronendorfer  
Qualification: V.P. Engineering  
Date: 09/01/2020

**What is covered**

RIDGID® tools are warranted to be free of defects in workmanship and material.

**How long coverage lasts**

This warranty lasts for the lifetime of the RIDGID® tool. Warranty coverage ends when the product becomes unusable for reasons other than defects in workmanship or material.

**How you can get service**

To obtain the benefit of this warranty, deliver via prepaid transportation the complete product to RIDGE TOOL COMPANY, Elyria, Ohio, or any RIDGID® AUTHORIZED INDEPENDENT SERVICE CENTER. Pipe wrenches and other hand tools should be returned to the place of purchase.

**What we will do to correct problems**

Warranted products will be repaired or replaced, at RIDGE TOOL'S option, and returned at no charge; or, if after three attempts to repair or replace during the warranty period the product is still defective, you can elect to receive a full refund of your purchase price.

**What is not covered**

Failures due to misuse, abuse or normal wear and tear are not covered by this warranty. RIDGE TOOL shall not be responsible for any incidental or consequential damages.

**How local law relates to the warranty**

Some states do not allow the exclusion or limitation of incidental or consequential damages, so the above limitation or exclusion may not apply to you. This warranty gives you specific rights, and you may also have other rights, which vary, from state to state, province to province, or country to country.

**No other express warranty applies**

This FULL LIFETIME WARRANTY is the sole and exclusive warranty for RIDGID® products. No employee, agent, dealer, or other person is authorized to alter this warranty or make any other warranty on behalf of the RIDGE TOOL COMPANY.



FULL LIFETIME WARRANTY (garantie légale étendue à la durée de vie du produit, voir conditions de garantie / legal warranty extended to the product lifecycle, see warranty conditions)

**Parts are available online at [Store.RIDGID.com](http://Store.RIDGID.com)**

**Ridge Tool Company**

400 Clark Street  
Elyria, Ohio 44035-6001  
U.S.A.

**Ce qui est couvert**

Les outils RIDGID® sont garantis contre tous vices de matériaux et de main d'oeuvre.

**Durée de couverture**

Cette garantie est applicable durant la vie entière de l'outil RIDGID®. La couverture cesse dès lors que le produit devient inutilisable pour raisons autres que des vices de matériaux ou de main d'oeuvre.

**Pour invoquer la garantie**

Pour toutes réparations au titre de la garantie, il convient d'expédier le produit complet en port payé à la RIDGE TOOL COMPANY, Elyria, Ohio, ou bien le remettre à un réparateur RIDGID® agréé. Les clés à pipe et autres outils à main doivent être ramenés au lieu d'achat.

**Ce que nous ferons pour résoudre le problème**

Les produits sous garantie seront à la discrétion de RIDGE TOOL, soit réparés ou remplacés, puis réex- pédiés gratuitement ; ou si, après trois tentatives de réparation ou de remplacement durant la période de validité de la garantie le produit s'avère toujours défectueux, vous aurez l'option de demander le rem- boursement intégral de son prix d'achat.

**Ce qui n'est pas couvert**

Les défaillances dues au mauvais emploi, à l'abus ou à l'usure normale ne sont pas couvertes par cette garantie. RIDGE TOOL ne sera tenue responsable d'aucuns dommages directs ou indirects.

**L'influence de la législation locale sur la garantie**

Puisque certaines législations locales interdisent l'exclusion des dommages directs ou indirects, il se peut que la limitation ou exclusion ci-dessus ne vous soit pas applicable. Cette garantie vous donne des droits spécifiques qui peuvent être éventuellement complétés par d'autres droits prévus par votre lég- islation locale.

**Il n'existe aucune autre garantie expresse**

Cette GARANTIE PERPETUELLE INTEGRALE est la seule et unique garantie couvrant les produits RIDGID®. Aucun employé, agent, distributeur ou tiers n'est autorisé à modifier cette garantie ou à offrir une garantie supplémentaire au nom de la RIDGE TOOL COMPANY.

**Qué cubre**

Las herramientas RIDGID® están garantizadas contra defectos de la mano de obra y de los materiales empleados en su fabricación.

**Duración de la cobertura**

Esta garantía cubre a la herramienta RIDGID® durante toda su vida útil. La cobertura de la garantía caduca cuando el producto se torna inservible por razones distintas a las de defectos en la mano de obra o en los materiales.

**Cómo obtener servicio**

Para obtener los beneficios de esta garantía, envíe mediante porte pagado, la totalidad del producto a RIDGE TOOL COMPANY, en Elyria, Ohio, o a cualquier Servicentro Independiente Autorizado de RIDGID®. Las llaves para tubos y demás herramientas de mano deben devolverse a la tienda donde se adquirieron.

**Lo que hacemos para corregir el problema**

El producto bajo garantía será reparado o reemplazado por otro, a discreción de RIDGE TOOL, y devuelto sin costo; o, si aún resulta defectuoso después de haber sido reparado o sustituido tres veces durante el período de su garantía, Ud. puede optar por recibir un reembolso por el valor total de su compra.

**Lo que no está cubierto**

Esta garantía no cubre fallas debido al mal uso, abuso o desgaste normal. RIDGE TOOL no se hace responsable de daño incidental o consiguiente alguno. au nom de la RIDGE TOOL COMPANY.

**Relación entre la garantía y las leyes locales**

Algunos estados de los EE.UU. no permiten la exclusión o restricción referente a daños incidentales o consiguientes. Por lo tanto, puede que la limitación o restricción mencionada anteriormente no rija para Ud. Esta garantía le otorga derechos específicos, y puede que, además, Ud tenga otros dere- chos, los cuales varían de estado a estado, provincia a provincia o país a país.

**No rige ninguna otra garantía expresa**

Esta GARANTIA VITALICIA es la única y exclusiva garantía para los productos RIDGID®. Ningún empleado, agente, distribuidor u otra persona está autorizado para modificar esta garantía u ofre- cer cualquier otra garantía en nombre de RIDGE TOOL COMPANY.